

SERGEZ WALLET INSTRUCTION SHEET

GRADING CATEGORY #1 PATTERN LAYOUT

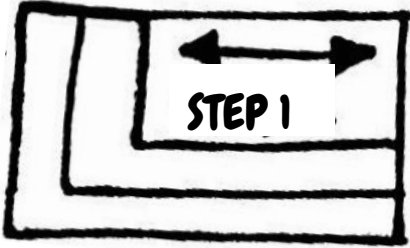

Make sure the grainline is parallel to the selvage edge.

1. SELECT WALLET SIZE:

Select your pattern for the size of wallet/bag you want to make.

- 6 1/2" x 11" - Smartphone Wallet
- 9" x 14" - Ipad Mini
- 11" x 17" - Large Bag
- 11" x 21" - IPAD Bag

2. CUT OUT LAYERS:

Lay out your pattern piece on grain with the fabric. Cut one layer of cotton/woven fabric, and one layer of polyester-fleece fabric.

GRADING CATEGORY #2 PATTERN ASSEMBLY

3. WALLET ASSEMBLY:

1. Match the layers up going the same direction. **MAKE SURE THE RIGHT SIDES ARE OUT.** Use your hand to press the layers together, so they will somewhat cling to each other.
2. On your SEWING MACHINE, change your stitch length to a 5. (for a BASTE STITCH)
3. Stitch the wallet pieces together around all four sides, on a 3/8" seam allowance. **AS PICTURED BELOW:**

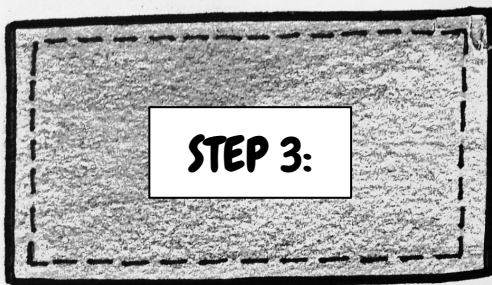

4. SERGE EDGES:

1. Serge the two short edges. **AS SHOWN IN THE DIAGRAM:** TRIM THREADS AFTER SERGING.

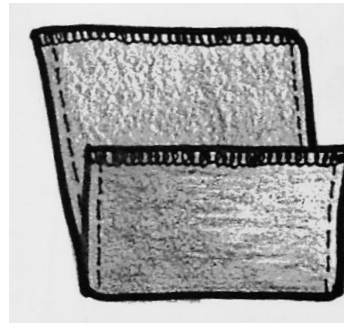
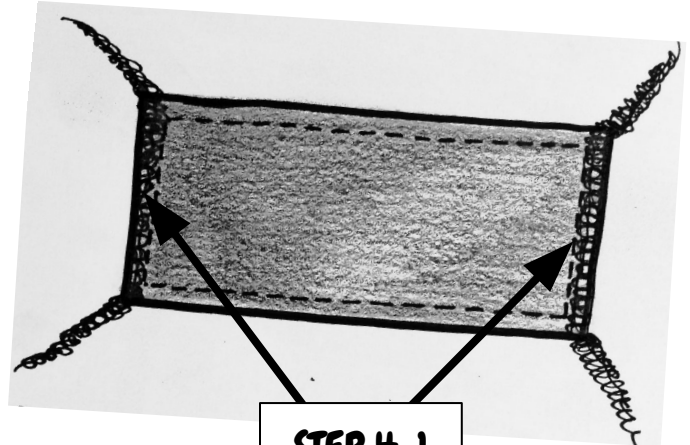

FOLD TO
HERE

2. Fold one edge of the rectangle up about 2/3 of the way up in the crosswise direction.

AS SHOWN IN THE DIAGRAM:
PRESS THE FOLD INTO PLACE.



3. In the folded position, serge the two longer sides, starting at the folded edge.

AS SHOWN IN DIAGRAM:
THIS WILL PREVENT THE SHORT EDGE FROM ACCIDENTALLY GETTING MANGLED UNDER THE PRESSER FOOT

FOLD THE FLAP DOWN AND PRESS. TRIM ALL HANGING THREADS.